

Information of C091D series









The QTY of contacts is 3-pin to 8-pin, the connection method for the thread type, pinhole connections for welding type, press-fit and PCB type. This series of connectors to prevent electromagnetic interference, protection level for IP67, GM AMPHENOLDE C091 series and BINDER 423 series. Comply with DIN45326 standards. Products are mainly used in industrial control, data processing equipment, test and medical equipment, communications, networking equipment, test as well as outdoor or marine and other occasions. Currently products are widely used in 3G networks.

Products characteristics

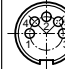
Rated voltage: 100V
rated impulse withstand voltage: 1200V
pollution degree: 1
installation type: 1
test voltage: 370V
rated current: 5A(40°C)
insulator resistance >1012Ω
contact resistance <5mΩ
temperature range: -40°C...+85°C
IP degree: IP67/IP65
life time >500, >1000
materials shell: Brass
insulator: PA66
sealing materials: rubber
plated: gold plated or silver plated
others contact type: solder
cable <=0.5mm²
UL 94 V0
locking system: metal screw coupling

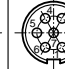
Characteristics C 091 D

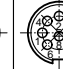
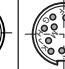
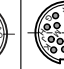
General Characteristics	Standard	Characteristics									
		3	4	5	5 Stereo	6	7	7	8	12	14
Number of contacts											
View on termination side of contact insert											
Contact arrangement acc. to DIN		41 524	-	-	41 524	45 322	-	45 329	45 326	-	-
Contact arrangement acc. to IEC		60130-9	60130-9	-	60130-9	60130-9	-	60130-9	60130-9	-	-
Electrical Characteristics											
Rated voltage	IEC 60664-1	300 V \approx			100V \approx	300 V \approx		100 V \approx		150 V \approx	
Rated voltage	UL 1977	250 V								60 V	
Rated impulse withstand voltage	IEC 60664-1	1500 V			1200 V	1500 V		1200 V			
Pollution degree	IEC 60664-1	1									
Installation category	IEC 60664-1	I									
Insulation group	IEC 60664-1	III CTI Δ 175									
Test voltage	IEC 60664-1	980 V \sim			670 V \sim	980 V \sim		670 V \sim			
Current rating	IEC 60512-3 Test 5 b	5 A / + 40 °C / + 104 °F									3 A / + 40 °C / + 104 °F
Insulation resistance	IEC 60512-2 Test 3 a	> 10 ¹² Ω									
Contact resistance	IEC 60512-2 Test 2 a	< 5 m Ω									
Climatical Characteristics											
Climatic category	IEC 60668-1	40 / 85 / 56									
Temperature range	IEC 60668-1	- 40 °C ... + 85 °C / - 40 °F ... + 185 °F									
Mechanical Characteristics											
IP-degree	IEC 60529	IP 67 / IP 65									
Insertion and withdrawal forces	IEC 60512-7 Test 13 b	25 N 90.oz	30 N 110.oz	35 N 125.oz	50 N 180.oz	55 N 200.oz	60 N 220.oz	50 N 180.oz			
Mechanical operation	IEC 60512-5 Test 9 a	Silver \geq 500 mating cycles Gold \geq 1000 mating cycles									
Materials											
Housing material		die cast, nickel plated									
Dielectric material		thermoplastic									
Sealing material		neoprene									
Contact plating		silver plated									
Further Characteristics											
Termination technique		solder, crimp								solder	
Wire gauge		solder \leq 0,5 mm ² (20-26 AWG), crimp 0,14 – 0,75 mm ² (26-18 AWG)								\leq 0,25 mm ² /24 AWG	
Flammability		UL 94 V0									
Locking system	IEC 60130-9	metal screw coupling									

Characteristics: Do not connect or disconnect under load. Metal housing parts shall be securely incorporated to protected ground.

C 091 D

Male cable connector



Description	Drawing	No. of cont.	Part Number solder termination Contact plating silver
Male cable connector . For cable diameter 6-8 mm termination: solder or crimp , contact plating: silver or gold .		3	C091 31 H003 101 2
		4	C091 31 H004 101 2
		5	C091 31 H005 101 2
		5S	C091 31 H105 101 2
		6	C091 31 H006 101 2
		7	C091 31 H007 101 2
		7	C091 31 H107 101 2
		8	C091 31 H008 101 2
		12	C091 31H012 101 2
		14	C091 31H014 101 2

Assembling instruction

Torque
0,5 - 1Nm/
1.8 - 3.6.oz

Kabel ø8

5)

20 2.5 28 2.5 20

C 091 D

Female cable connector



Description	Drawing	No. of cont.	Part Number solder termination	Contact plating
-------------	---------	--------------	--------------------------------	-----------------

Female cable connector.
For cable diameter 6-8 mm,
termination: solder or crimp,
contact plating: silver or gold.

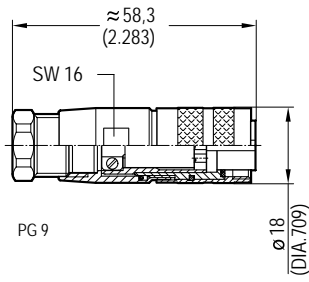

3	C091 31D003 101	2
4	C091 31D004 101	2
5	C091 31D005 101	2
5S	C091 31D105 101	2
6	C091 31D006 101	2
7	C091 31D007 101	2
7	C091 31D107 101	2
8	C091 31D008 101	2
12	C091 31D012 101	2
14	C091 31D014 101	2

Assembling instruction

Torque
0,5 - 1Nm/
1.8 - 3.6.oz

Kabel ø8

C 091 D

Female receptacle
for rear mounting

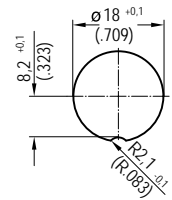
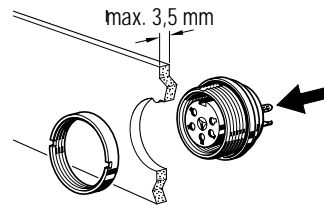

Panel cutout

Description	Drawing	No. of cont.	Part Number solder termination	Contact plating
Female receptacle, termination: solder or crimp, contact plating: silver or gold, panel mounting with ring nut sealing with O-Ring .		3	C091 31G003 100	2
		4	C091 31G004 100	2
		5	C091 31G005 100	2
		5S	C091 31G105 100	2
		6	C091 31G006 100	2
		7	C091 31G007 100	2
		7	C091 31G107 100	2
		8	C091 31G008 100	2
		12	C091 31G012 100	2
		14	C091 31G014 100	2

C 091 D

Male receptacle
for rear mounting

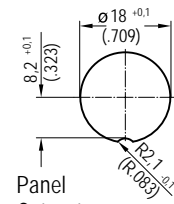
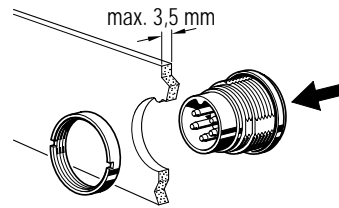

Panel Cutout

Description	Drawing	No. of cont.	Part Number solder termination	Contact plating
Male receptacle , termination: solder or crimp, contact plating: silver or gold, panel mounting with ring nut, sealing with O-Ring .		3	C091 31C003 100	2
		4	C091 31C004 100	2
		5	C091 31C005 100	2
		5S	C091 31C105 100	2
		6	C091 31C006 100	2
		7	C091 31C007 100	2
		7	C091 31C107 100	2
		8	C091 31C008 100	2
		12	C091 31C012 100	2
		14	C091 31C014 100	2

Part No. system for
crimp contacts

C091 - 31H 005 - 1 01 - 2

1 2 3 4 5 6

1. Model
2. Socket type: 31H — male cable connector, 31D — female cable connector, 31C — male receptacle for rear mounting, 31G — female receptacle for rear mounting.
3. Number of contacts
4. Contact plating: 1 — silver, 2 — gold
5. Cable size: 01 — 8mm
6. The addition