

## Series K

### Technical Characteristics

#### Mechanical and Climatical

Characteristics	Value	Standard
Endurance	> 5000 cycles	IEC 60512-5 test 9a
Humidity	up to 95% at 60° C	
Temperature range	- 55° C, +250° C	
Resistance to vibration	10-2000 Hz, 15 g	IEC 60512-4 test 6d
Shock resistance	100 g, 6 ms	IEC 60512-4 test 6c
Salt spray corrosion test	> 144h	IEC 60512-6 test 11f
Protection index (mated)	IP50	IEC 60529
Climatical category	55/175/21	IEC 60068-1

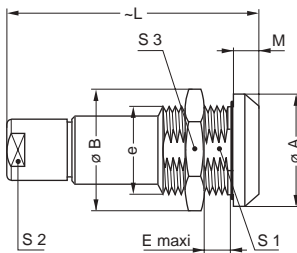
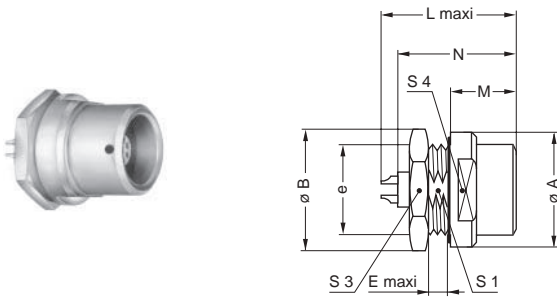

## Metal housing models

#### Electrical

Characteristics	Value	Standard	
Shielding efficiency	at 10 MHz	> 75 dB	IEC 60169-1-3
	at 1 GHz	> 40 dB	IEC 60169-1-3

**Note:**

the various tests have been carried out with FGG and EGG connector pairs, with chrome-plated brass shell and PEEK insulator.

#### EHG Fixed socket, nut fixing, key (G) or keys (A to F and L), protruding shell

Reference		Dimensions (mm)									
Model	Series	A	B	e	E	L	M	N <sup>1)</sup>	S1	S3	S4
EHG	0K	18	19.2	M14x1.0	1.5	21.7	10.5	20.1	12.5	17	15
EHG	1K	20	21.5	M16x1.0	1.5	27.0	15.5	25.1	14.5	19	17
EHG	2K	25	27.0	M20x1.0	1.5	30.7	17.0	27.1	18.5	24	20

**Note:** <sup>1)</sup> maximum length with crimp contacts.

#### PKG Fixed socket, nut fixing, key (G) or keys (A to F, L and R), cable collet

Reference		Dimensions (mm)								
Model	Series	A	B	e	E	L	M	S1	S2	S3
PKG	0K	18	19.2	M14x1.0	6.0	34.0	4.0	12.5	8	17
PKG	1K	20	21.5	M16x1.0	9.0	45.0	4.5	14.5	9	19
PKG	2K	25	27.0	M20x1.0	9.0	54.0	5.0	18.5	12	24

## Order information K

FG G - 2 K - 310 - C L A C 65 Z  
1 2 3 4 5 6 7 8 9 10 11

1. Model: F — plug; E — cable receptacle; H — waterproof receptacle;  
P — receptacle; X — receptacle PCB soldering
2. Key
3. Size
4. Series
5. Number of contacts: 306 - 10 contacts
6. Body material: C — chromium-plate brass
7. Insulator material: L — PEEK; Y — PEEK, long insulator, crimp
8. Type of pin: L — socket, solder; A — pin; M — socket, crimp;  
Y — socket, crimp; V — socket, elbow print
9. Collet mechanism: C — collet for K socket
10. Collet diameter: 62 — 6,5 mm
11. Z - shock absorber for cable, option

## Alignment Key

Series K

### Alignment Key and Polarized Keying System

K series connector model part numbers are composed of three letters. The LAST LETTER indicates the key position and the contact type (male or female).

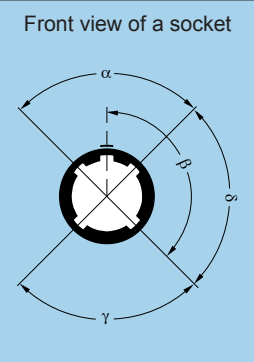
Front view of a socket 	Reference	Nb of keys	Angles	Series			Contact type	
				0K	1K	2K	Plug	Socket
	G	1		0°	0°	0°	male	female
	A	2		30°	30°	30°	male	female
	B	2	$\alpha$	45°	45°	45°	male	female
	C	2		60°	60°	60°	male	female
	D	2	$\gamma$	95°	95°	95°	male	female
	E	2		120°	120°	120°	male	female
	F	2	$\beta$	145°	145°	145°	male	female
	L	2	$\gamma$	75°	75°	75°	female	male

**Note:**

- First choice alternative
- Special order alternative