

Series B

Technical Characteristics

Mechanical and Climatical

Characteristics	Value	Standard
Endurance	> 5000 cycles	IEC 60512-5 test 9a
Humidity	up to 95% at 60° C	
Temperature range	-55° C, +250° C	
Resistance to vibration	10-2000 Hz, 15 g	IEC 60512-4 test 6d
Shock resistance	100 g, 6 ms	IEC 60512-4 test 6c
Salt spray corrosion test	> 144h	IEC 60512-6 test 11f
Protection index (mated)	IP50	IEC 60529
Climatical category	55/175/21	IEC 60068-1

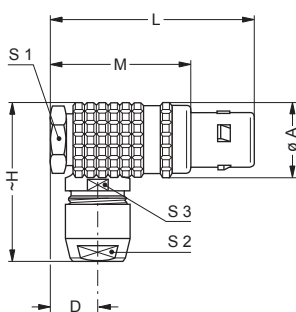
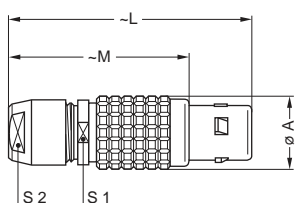
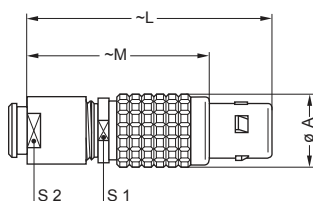

Metal housing models

Electrical

Characteristics	Value	Standard	
Shielding efficiency	at 10 MHz	> 75 dB	IEC 60169-1-3
	at 1 GHz	> 40 dB	IEC 60169-1-3

Note:

the various tests have been carried out with FGG and EGG connector pairs, with chrome-plated brass shell and PEEK insulator.

FGG Straight plug, key (G) or keys (A...M), cable collet and nut for fitting a bend relief ²⁾

Reference		Dimensions (mm)				
Model	Series	A	L	M	S1	S2
FGG	00 ¹⁾	6.4	28.7	20.7	5.5	6
FGG	0B	9.5	35.0	25.0	8.0	7
FGG	1B	12.0	42.0	31.0	10.0	9
FGG	2B	15.0	49.0	37.0	13.0	12

Note: ¹⁾ the surface design of the 00 series is different.
²⁾ to order, add a «Z» at the end of the reference.

FGG Straight plug, key (G) or keys (A...M and R), cable collet

Reference		Dimensions (mm)				
Model	Series	A	L	M	S1	S2
FGG	00 ¹⁾	6.4	28.5	20.5	5.5	5
FGG	0B	9.5	36.0	26.0	8.0	7
FGG	1B	12.0	43.0	32.0	10.0	9
FGG	2B	15.0	50.0	38.0	13.0	12

Note: ¹⁾ the surface design of the 00 series is different.

FHG Elbow (90°) plug, key (G) or keys (A...M and R), cable collet

Reference		Dimensions (mm)							
Model	Series	A	D	H	L	M	S1	S2	S3
FHG	00 ¹⁾	7.7	5.2	18.0	24.5	16.5	7	5	5.5
FHG	0B	11.0	6.5	26.0	31.6	21.6	10	7	8.0
FHG	1B	13.5	8.0	30.5	36.0	25.0	11	9	10.0
FHG	2B	16.5	9.0	34.0	41.5	29.5	14	12	13.0

Note: ¹⁾ the surface design of the 00 series is different.

Order information B

FG G - 0 B - 306 - C L A D 62 Z
 1 2 3 4 5 6 7 8 9 10 11

1. Model: F — plug; E — cable receptacle; H — waterproof receptacle;
 P — receptacle; X — receptacle PCB soldering
2. Key
3. Size
4. Series
5. Number of contacts: 306 - 6 contacts
6. Body material: C — chromium-plate brass
7. Insulator material: L — PEEK; Y — PEEK, long insulator, crimp
8. Type of pin: L — socket, solder; A — pin; M — socket, crimp;
 Y — socket, crimp; V — socket, elbow print
9. Collet mechanism: D — collet for B socket
10. Collet diameter: 62 — 6,2mm
11. Z - shock absorber for cable, option

Alignment Key

Series B

Alignment Key and Polarized Keying System

K series connector model part numbers are composed of three letters. The LAST LETTER indicates the key position and the contact type (male or female).

Front view of a socket	Reference	Nb of keys	Angles	Series				Contact type	
				00	0B	1B	2B	Plug	Socket
	G	1		0°	0°	0°	0°	male	female
	A	2	α	30°	30°	30°	30°	male	female
	B	2		60°	60°	60°	45°	male	female
	C	2		—	90°	90°	60°	male	female
	D	2	β	—	135°	135°	95°	male	female
	E	2		—	145°	145°	120°	male	female
	F	2		—	155°	155°	145°	male	female
	J	2		45°	45°	45°	37.5°	female	male
	K	2	γ	—	70°	70°	52.5°	female	male
	L	2		—	80°	80°	70°	female	male
	M	2		δ	—	110°	—	—	female

Note:

- First choice alternative
- Special order alternative